



**VONROC®**

BUILD YOUR FUTURE

**ELECTRIC ROLLER BLIND**  
**RB501DC / RB502DC / RB503DC / RB504DC**  
**RB505DC / RB506DC / RB507DC**  
**BLACK / GREY / WHITE**



<b>EN</b> Original Instructions	06
<b>NL</b> Vertaling van de oorspronkelijke gebruiksaanwijzing	00
<b>FR</b> Traduction de la notice originale	00

## INSTALLING ROLLERBLIND

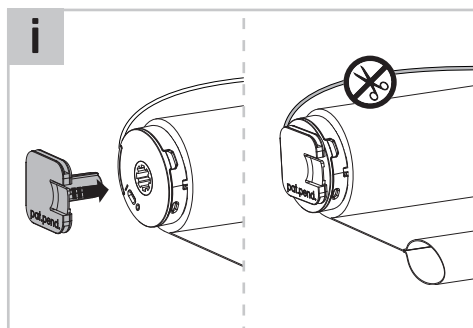
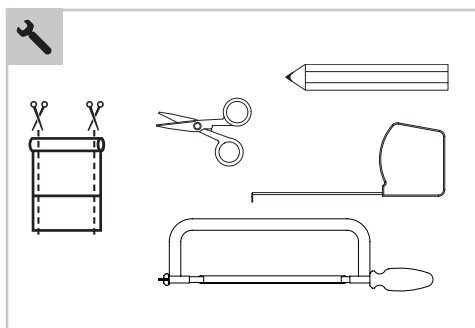
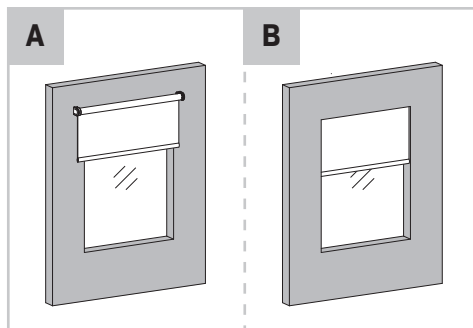
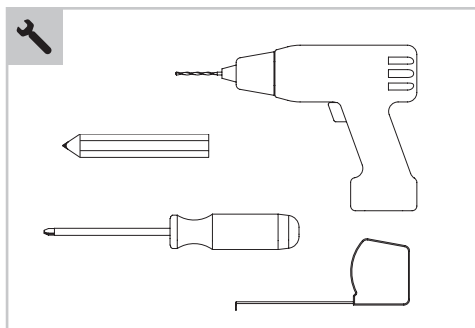
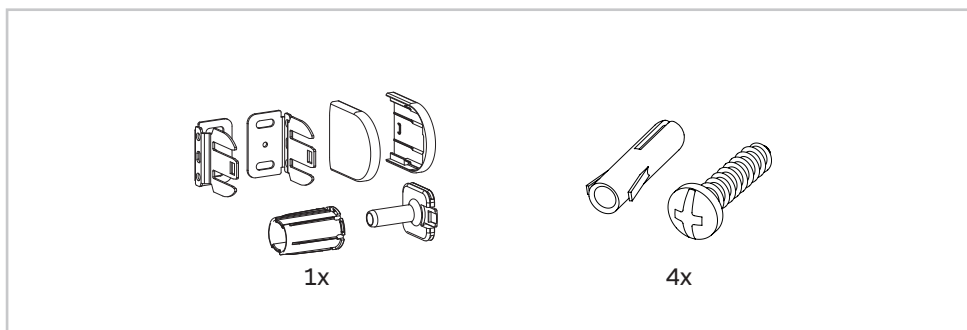
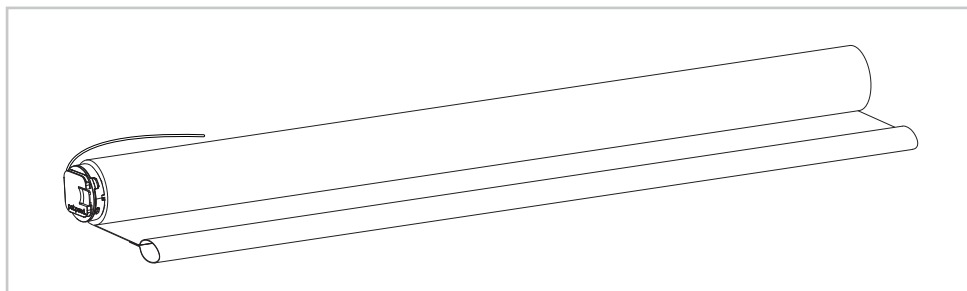

**A**

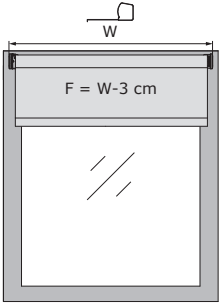

**B**

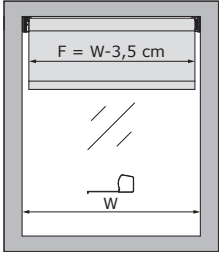

**1**

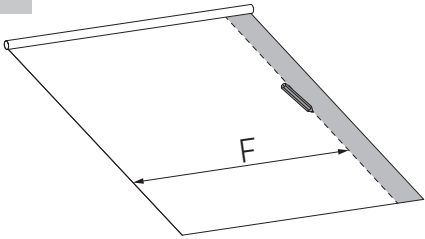

**2**

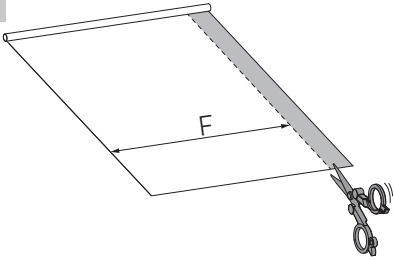

**3**

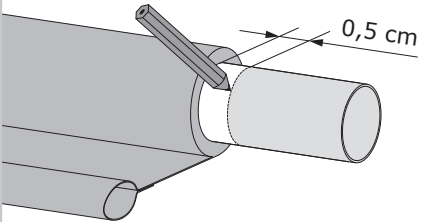

**4**

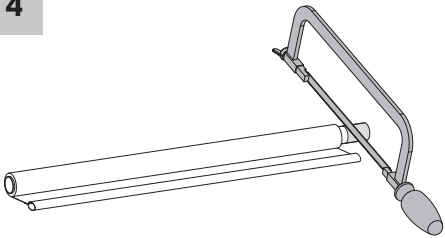

**5**

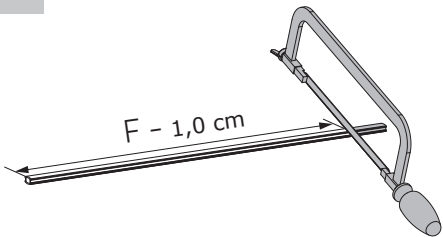

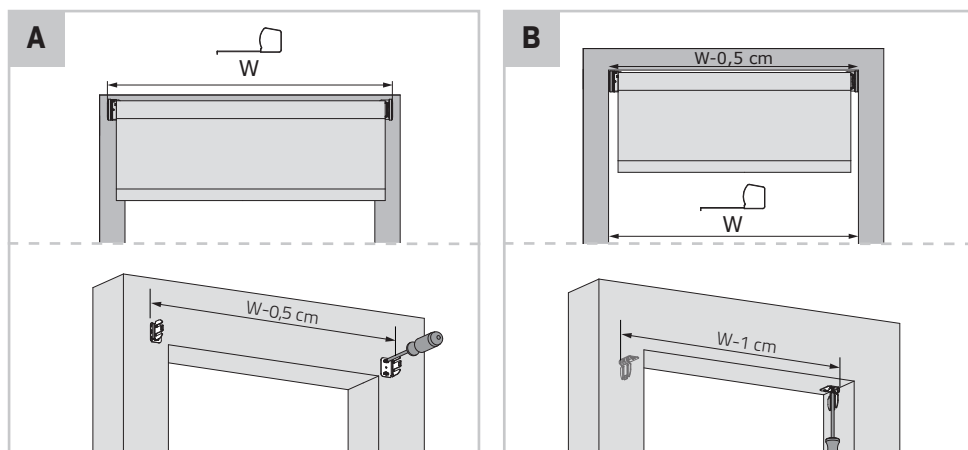

# **1 ACTIVATE THE MOTOR**

Activate the motor by moving the switch to 1.

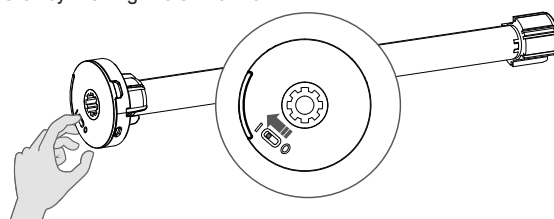

# **2**

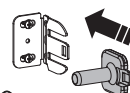

Click!

# **3**

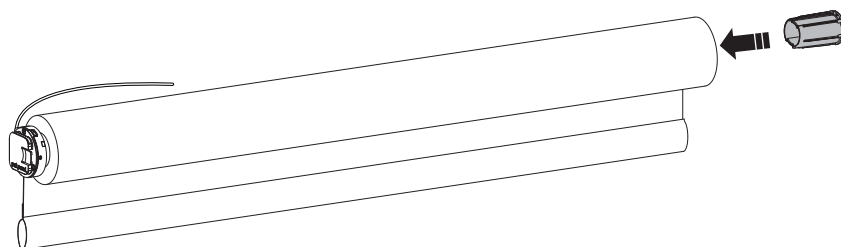

4

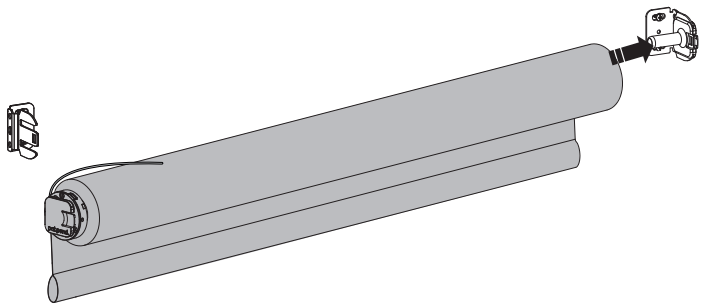

5

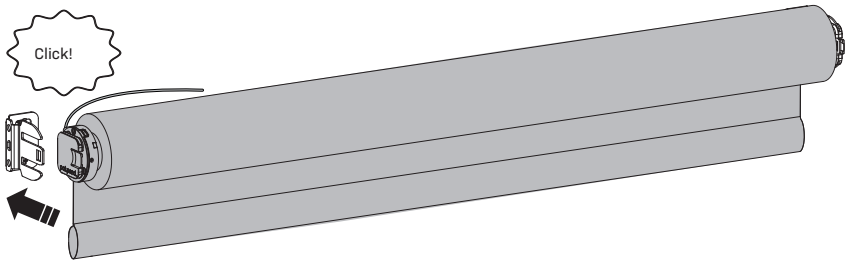

6

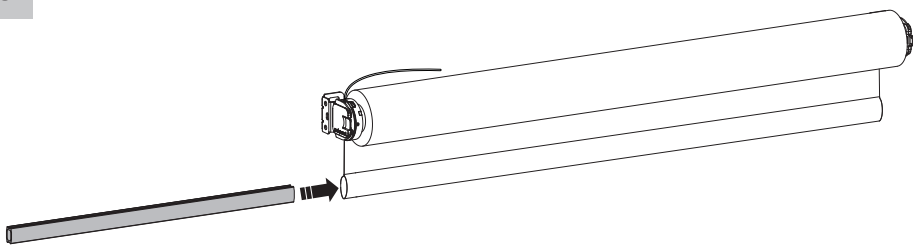

7

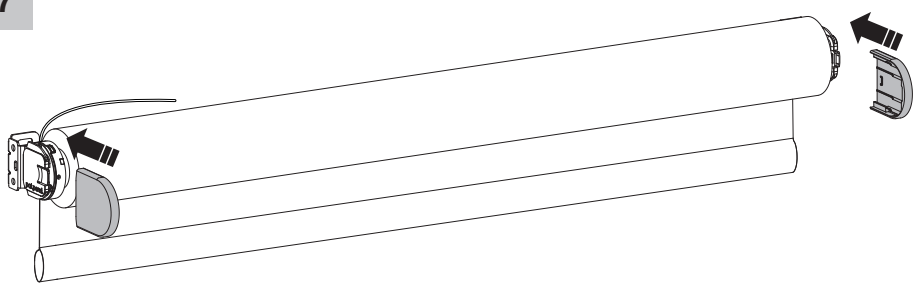

**ACTIVATE THE BLIND**

Follow the steps in the online manual  
CMD-02 to activate the blind:

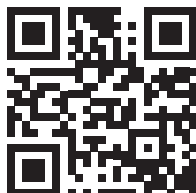

[rtube.nl/red1942](http://rtube.nl/red1942)

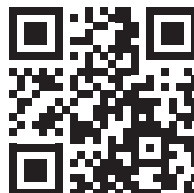
**FOR MORE INFORMATION  
AND SUPPORT:**

[rtube.nl/red1943](http://rtube.nl/red1943)

## 1. SAFETY INSTRUCTIONS

Read the enclosed safety warnings, the additional safety warnings and the instructions. Failure to follow the safety warnings and the instructions may result in electric shock, fire and/or serious injury. Save the safety warnings and the instructions for future reference.

The following symbols are used in the user manual or on the product:



*Read the user manual.*



*Indoor use only.*



*Do not dispose of the product in unsuitable containers.*



*The product is in accordance with the applicable safety standards in the European directives.*

### GENERAL SAFETY WARNING

This appliance can be used by children aged from 8 years and above and persons with reduced physical, sensory or mental capabilities or lack of experience and knowledge if they have been given supervision or instruction concerning use of the appliance in a safe way and understand the hazards involved. Children shall not play with the appliance. Cleaning and user maintenance shall not be made by children without supervision.

Children of less than 3 years should be kept away unless continuously supervised. Children aged from 3 years and less than 8 years shall only switch on/off the appliance provided that it has been placed or installed in its intended normal operating position and they have been given supervision or instruction concerning use of the appliance in a safe way and understand the hazards involved. Children aged from 3 years and less than 8 years shall not plug in, regulate and clean the appliance or perform user maintenance.

### ADDITIONAL SAFETY WARNINGS FOR ELECTRICAL ROLLER BLINDS

**WARNING:** To reduce the risk of severe injury or death, it is important to follow these instructions for personal safety. Save these instructions.

- Read and follow all installation instructions
- Young children can strangle themselves with the loop of pull cords, chains and tapes and cords that operate window coverings.
- To avoid strangulation and entanglement, keep cords out of reach of young children.
- Cords may ensnare a child's neck
- Move beds, cots and furniture away from window covering cords
- Do not tie cords together
- Make sure cords do not twist together and form a loop
- Do not perform repairs yourself.
- Do not attempt to open the device or disassemble it. You run the risk of electric shock and voiding the limited warranty. No user-serviceable parts are inside.
- This appliance can be used by children aged 8 years and above and persons with reduced physical, sensory or mental capabilities or lack of experience and knowledge if they have been given supervision or instruction concerning use of the appliance in a safe way and understand the hazards involved. Children should not play with the appliance. Cleaning and user maintenance should not be performed by unsupervised children.
- Do not allow children to play with fixed controls. Keep remote controls away from children.
- Frequently examine the installation for imbalance and signs of wear or damage to cables and springs. Do not use if repair or adjustment is necessary
- The drive must be disconnected from its power source during cleaning, maintenance and when replacing parts.
- The A-weighted emission sound pressure level of the drive is equal to or less than 70 dB(A).
- Indoor and household use only
- Disconnect the drive from the power supply or switch off the automatic controls when maintenance, such as window cleaning is being carried out in the vicinity
- When operating a biased switch, make sure that other persons are kept away
- Do not operate when maintenance, such as window cleaning, is being carried out in the vicinity
- The tube motor must only be supplied with safety extra low voltage corresponding to the marking on the appliance

- This appliance contains batteries that are non-replaceable

### Electrical safety

When using electric machines always observe the safety regulations applicable in your country to reduce the risk of fire, electric shock and personal injury. Read the following safety instructions and also the enclosed safety instructions.



*Always check that the voltage of the power supply corresponds to the voltage on the rating plate.*



*If the supply cord of this power tool is damaged, it must be replaced by a specially prepared supply cord available through the service organization.*

## 2. MACHINE INFORMATION

### Intended use

The electrical roller blinds is intend for indoor, non-commercial, household use for blinding windows. Do not use the product for any other purpose. Assembly can be completed by non-professionals.

## 3. INSTALLATION

**WARNING:** Important safety instructions. Follow all instructions, since incorrect installation can lead to severe injury

### MOTOR

- The motor can only be used with soft material for driven parts
- Hazardous unprotected moving parts of the drive must be installed higher than 2.5m above the floor or any other level surface that could provide access to it.
- Install the actuating members of a manual release at a height of less than 1.8m
- The actuating member of a biased switch is to be located within direct sight of the driven part but away from moving parts. It is to be installed at a minimum height of 1.5m and not accessible to the public
- The mass and the dimension of the driven part must be compatible with the rated torque and rated operating time
- Fixed controls have to be clearly visible after installation
- The driven part must be compatible with the rated torque (0.3N.m) and rated operating time (12min).
- Minimum tube diameter motor: ø25mm.
- The drive is intended to be installed at a height of at least 2.5m above floor or any other accessible level surface.
- All-pole disconnection switches must be incorporated in the fixed wiring in accordance with the wiring rules.
- The appliance must only be supplied at safety extra low voltage corresponding to the marking on the appliance
- Before installing the drive, remove any unnecessary cords or components and disable any equipment not needed for powered operation.
- The battery must be removed from the appliance before it is scrapped. The appliance must be disconnected from the supply mains when removing the battery. The battery is to be disposed of safely.

## 4. OPERATION



*Check the device for damage before use and only use in good working condition.*

## 5. MAINTENANCE



*Before cleaning and maintenance, always switch off the machine.*



*Always disconnect the machine from the main power supply before carrying out any maintenance work.*

- Use a damp, soft, lint-free cloth. Avoid getting moisture in openings
- Do not use aerosol sprays, solvents, alcohol or abrasives.

## ENVIRONMENT



*Faulty and/or discarded electrical or electronic apparatus have to be collected at the appropriate recycling locations.*

**Only for EC countries**

Do not dispose of power tools into domestic waste. According to the European Guideline 2012/19/EU for Waste Electrical and Electronic Equipment and its implementation into national right, power tools that are no longer usable must be collected separately and disposed of in an environmentally friendly way.

**WARRANTY**

VONROC products are developed to the highest quality standards and are guaranteed free of defects in both materials and workmanship for the period lawfully stipulated starting from the date of original purchase. Should the product develop any failure during this period due to defective material and/or workmanship then contact VONROC directly.

The following circumstances are excluded from this guarantee:

- Repairs and or alterations have been made or attempted to the machine by unauthorized service centers;
- Normal wear and tear;
- The tool has been abused, misused or improperly maintained;
- Non-original spare parts have been used.

This constitutes the sole warranty made by company either expressed or implied. There are no other warranties expressed or implied which extend beyond the face hereof, herein, including the implied warranties of merchantability and fitness for a particular purpose. In no event shall VONROC be liable for any incidental or consequential damages. The dealers remedies shall be limited to repair or replacement of nonconforming units or parts.

**The product and the user manual are subject to change. Specifications can be changed without further notice.**





**DECLARATION OF CONFORMITY**  
**RB501DC / RB502DC / RB503DC / RB505DC / RB506DC / RB507DC**  
**BLACK / GREY / WHITE - ELECTRIC ROLLER BLIND**

- (EN) We declare under our sole responsibility that this product is in conformity with directive 2011/65/EU of the European parliament and of the council of 8 June on the restriction of the use of certain hazardous substances in electrical and electronic equipment is in conformity and accordance with the following standards and regulations:
- (NL) Wij verklaren onder onze volledige verantwoordelijkheid dat dit product voldoet aan de conform Richtlijn 2011/65/EU van het Europees Parlement en de Raad van 8 juni 2011 betreffende beperking van het gebruik van bepaalde gevaarlijke stoffen in elektrische en elektronische apparatuur en in overeenstemming is met de volgende standaarden en reguleringen:
- (FR) Nous déclarons sous notre seule responsabilité que ce produit est conforme aux standards et directives suivants: est conforme à la Directive 2011/65/EU du Parlement Européen et du Conseil du 8 juin 2011 concernant la limitation d'usage de certaines substances dangereuses dans l'équipement électrique et électronique.

**EN 55014-1:2017/A11:2020, EN 55014-2:2015, EN 61000-3-2:2014,  
EN IEC 61000-3-2:2019, EN 61000-3-3:2013 EN 61000-3-3:2013/A1:2019,  
EN 301 489-1 V2.2.3:2019, FINAL DRAFT EN 301 489-3 V2.2.0,  
EN 300 220-2 V3.1.1:2017, EN 50663:2017, EN 60335-2-97:2016/A12:2015,  
EN 62233:2008, EN 60335-1:2012/A2:2019, EN IEC 55014-1:2021, EN IEC 55014-2:2021**

Zwolle, 01-04-2023

H.G.F Rosberg  
CEO



©2023 VONROC  
[WWW.VONROC.COM](http://WWW.VONROC.COM)

2304-12

Coulisse Manual No.  
MN230022